

# 球场屏

LED Stadium Display

## 产品特点 CHARACTERISTICS

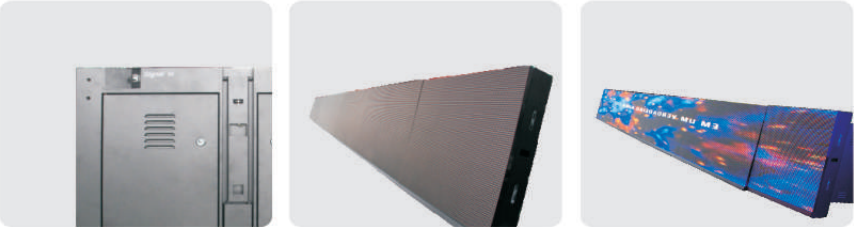

双备份：两台电脑同时控制，当一台电脑出现问题，另一台自动接替，确保显示屏正常工作。

高刷新：刷新频率高达4800Hz，满足运动场动态拍摄的需要，有效避免拍摄时的闪烁现象。

设计独特：箱体采用独特倾角(75~90°)可调设计，让所有的观众都能看到播放的内容。

保护性强：专门选用选用软面罩，既能保护led灯又不会因运动员碰撞而造成明显伤害。

实时性强：采用高效光纤传输系统，有效减少信号延迟现象，保证了画面播放一致性。

防水性强：IP65防护等级，显示屏在雨天天气里能够为您继续工作。

Automatic backup system : Apexls LED displays could utilize two computers to ensure interruption-free display of images and videos. For instance, if one unit was to turn off due to technical issues, the other unit will automatically act as a backup solution.

High refresh rates : With 4800Hz refresh rates, our products can display flicker-free video images, including live sports video .w

Unique design : The cabinet with adjustable inclination angle(75—90) design enable all the audience to enjoy the display contents.

Impact resistance : Specially designed soft module masks on our products protect players from injury and offers protection to the unit itself.

Speed update System : high-effective fiber transfer system is designed to ensure speed update of information and the uniformity of the image.

Outstanding performance in all weather : With IP65 rate, our cabinets can be protected away from rain or water damage and work soundly in rain.



## 应用领域 APPLICATION

广泛应用足球形、棒球场、网球场等。可随意播放视频、图文 图像并茂的节目，并以实时、同步、清晰的信息传播方式播放各种信息。

Widely used in football fields, baseball fields and tennis courts etc, can vividly play items such as text, picture and video and play of clear information can be realized at the same time.

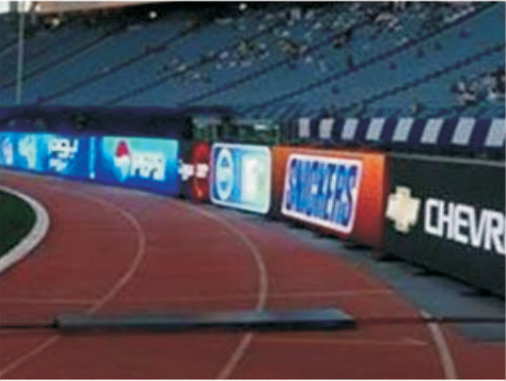

## 产品图片 PRODUCT PICTURE



## 产品系列 Product series



## 产品尺寸 SPECIFICATIONS

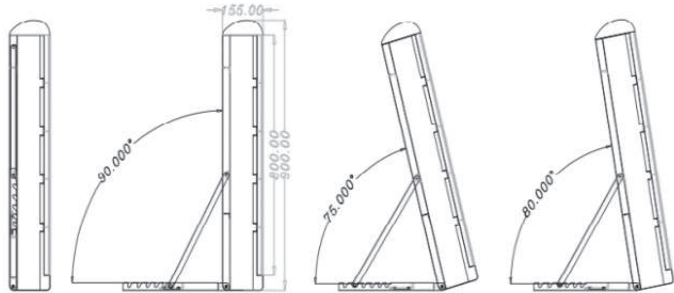

## 产品参数 PARAMETER ( 尺寸可订制 Size can be customized )

Specification	规格型号	Ph10	Cabinet Area	整体面积	0.768m²
Pixel Pitch	像素点间距	10mm	Refresh Frequency	刷新率	600HZ~1500HZ
Pixel Composing	像素点组成	1R1G1B	Grey Grade	灰度等级	4096~65536
Pixel Density	像素点密度	10000pixels/m²	Input Voltage (AC)	Ac输入电压	110~240V ±10%
LED Encapsulation	LED封装	DIP 346	Brightness Adjustment	电源输入频率	50/60HZ
Driven Method	扫描方式	1/4 scan	Color Temperature	亮度调节级别	256级自动或手动调节 Auto or manual adjustment
Screen Brightness	屏幕亮度	≥7000cd/m2	Working Temperature	色温	3200K~9500K可调 adjustable
Cabinet Average power	整箱平均功率	186W	Working Humidity	工作温度范围	—20℃ ~ 60℃
Cabinet Maximum Power	整箱最大功率	432W	Life Span	工作湿度范围	10% ~ 90%
Using Environment	使用环境	户外 outdoor	Brightness Uniformity	正常使用寿命	≥100000 hours
Module Resolution	整箱分辨率	96*80	MTBF	平均无故障时间	≥5000
Cabinet Size	整体尺寸	960mm*800mm	Defective Dot Rate	杂点率	<0.0001



# 漏斗屏

LED Cube for Basketball Stadium

## 产品特点 CHARACTERISTICS

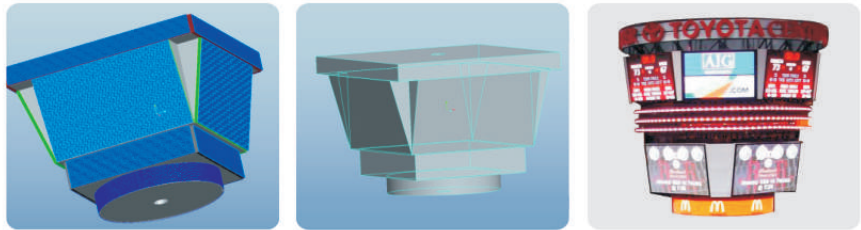

箱体采用独特的倾角可调设计，我们的球场屏能够根据不同的要求调节箱体的倾斜角度(75° ~90° )，让所有的观众都能看到播放的内容。

- 采用高效的光纤传输系统，有效减少了足球场上传输距离较远而造成信号延迟现象，保证了画面播放一致性。
- 具有双网线热备份功能，两台电脑同时控制一块屏，当一台电脑出现问题时，另一台电脑自动接替，确保显示屏正常工作。
- 防水效果好，拥有IP65的防护等级，这样使得显示屏在雨天天气里能够为您继续工作。
- 配有专有的球场播放软件，让您十分方便的进行比分管理，节目回放、广告播出和节目表的编辑。
- 拥有高达4800Hz的刷新频率，满足运动场上动态拍摄的需要，有效避免了拍摄时的闪烁现象。

Unique cabinet design : The cabinet with adjustable inclination angle(75°~90°) design enable all the audience to enjoy the display contents.

Speed update System : high-effective fiber transfer system is designed to ensure speed update of information and the uniformity of the image.

Automatic backup system : Apexls LED displays could utilize two computers to ensure interruption-free display of images and videos. For instance, if one unit was to turn off due to technical issues, the other unit will automatically act as a backup solution.

Outstanding performance in all weather : With IP65 rate, our cabinets can be protected away from rain or water damage and work soundly in rain.

Customized playing software : The software designed for sports makes it convenient in scoring, video rewinding, advertisement playing and program editing.

High refresh rates : With 4800Hz refresh rates, our products can display flicker-free video images, including live sports video .

## 应用领域 APPLICATION

广泛应用大型体育场馆、休闲广场、电视节目直播现场、展览场馆、大型娱乐广场、繁华商贸中心、商业街、火车站等。可随意播放视频、图文、图像并茂的节目,并以实时、同步、清晰的信息传播方式播放各种信息。

Widely used in large-scale gymnasium, entertainment square, TV live site , Exhibition Venues , commerce heart , business street and train station etc. can vividly play items such as text, pictureand video and play of clear information can be realized at the same time.



## 产品图片 PRODUCT PICTURE

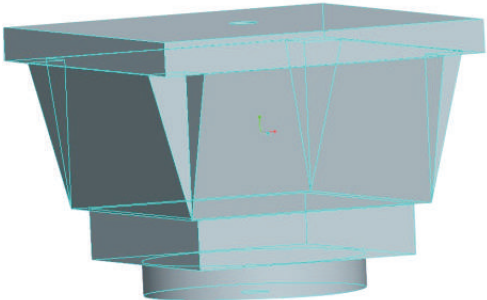

## 产品尺寸 SPECIFICATIONS

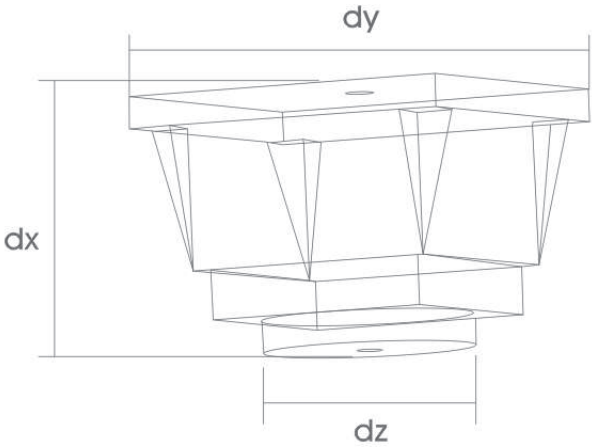

## 产品参数 PARAMETER ( 尺寸可订制 Size can be customized )

Specification	规格型号	Ph5
Pixel Pitch	像素点间距	5mm
Pixel Composing	像素点组成	1R1G1B
Pixel Density	像素点密度	40000pixels/m²
LED Encapsulation	LED封装	3528
Driven Method	扫描方式	1/8 scan
Screen Brightness	屏幕亮度	≥1500cd/m2
CabinetAverage Power	整箱平均功率	99W
CabinetMaximum Power	整箱最大功率	230W
Using Environment	使用环境	户内/indoor
Module Resolution	整箱分辨率	96*96
Cabinet Size	整体尺寸	480mm*480mm

Refresh Frequency	刷新率	600HZ~1500HZ
Grey Grade	灰度等级	4096~65536
Input Voltage (AC)	Ac输入电压	110~240V ± 10%
Input Frequency(power)	电源输入频率	50/60HZ
Brightness Adjustment	亮度调节级别	256级自动或手动调节 Auto or manual adjustment
Color Temperature	色温	15000K~20000K可调 adjustable
Working temperature	工作温度范围	—20℃ ~60℃
Working Humidity	工作湿度范围	10% ~ 90%
Life Span	正常使用寿命	≥ 100000 hours
MTBF	平均无故障时间	≥ 5000 hours
Defective Dot Rate	杂点率	<0.0001



地砖屏

LED Floor Display

产品特点

CHARACTERISTICS

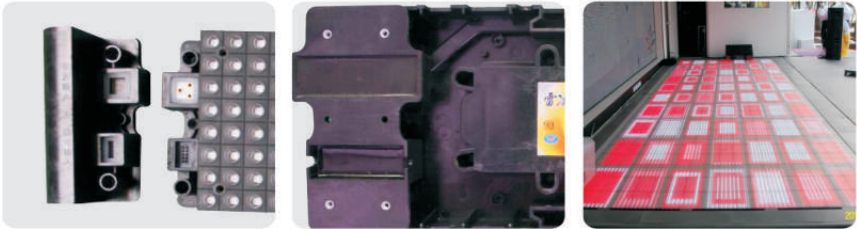

- 1.模块化结构. Modular design structure
- 2.拆装快捷. Easy to install and dismantle
- 3.无缝拼接. Seamless Connection between modules
- 4.最好的台阶屏体. The best stair led screen body
- 5.可实现异性背景.It can realize different background
- 6.超强承重，每平方承重1.5T以上. Strong load bearing capacity, more than 1.5T/m<sup>2</sup>
- 7.可大面积应用在舞台上. Can function as wonderful stage in large scale

应用领域

APPLICATION

广泛应用各种晚会舞台、演唱会舞台、产品广告舞台等场所，可随意播放视频、图文、图像并茂的节目，并以实时、同步、清晰的信息传播方式播放各种信息。

As a wonderful ,new type of stage, Floor LED Display can be widely applied in concert , carnival, fashion show, party and many other places. It can synchronouslyshow vivid picture ,video and any information with highresolution.

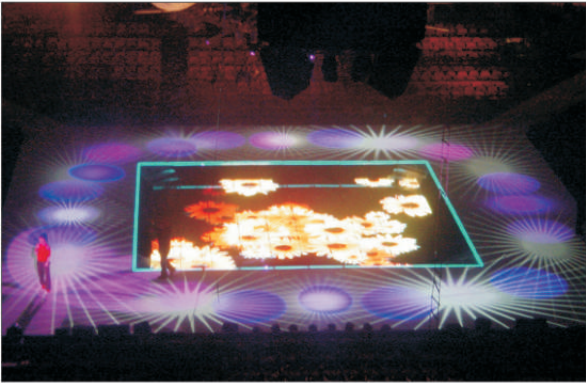

产品图片

PRODUCT PICTURE



产品系列

Product series



产品尺寸

SPECIFICATIONS

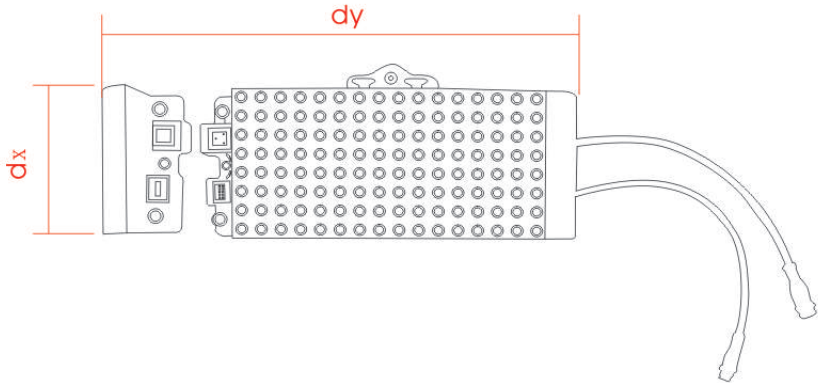

产品参数

PARAMETER ( 尺寸可订制 Size can be customized )

Specification	产品规格	ph10	Refresh Frequency	刷新频率	600Hz~1500Hz
Pixel Pitch	像素点间距	10mm	Contrast Ratio	对比度	10000:1
Module Resolution	模块分辨率	32*16 pixels	Input Voltage	供电电压	AC110V~240V,50~60Hz
Pixel Composition	像素点组成	1R1G1B	Power (Max/Average)	功耗(最大/平均)	638W/m <sup>2</sup> (320 W/m <sup>2</sup> )
Pixel Density	像素点密度	10000 pixes/m <sup>2</sup>	Working Temperature	工作温度	-20℃ ~ +50℃
Cabinet Material	箱体材质	碱性PC/alkaline PC	Store Temperature	存储温度	-35℃ ~ +85℃
Cabinet Weight	箱体重量	1kg	Humidity	工作湿度	10%—90%RH
Bearing Capacity	承重能力	280kg	Service Time	使用寿命	≥5 hours
Brightness	亮度	≥1400CD/m <sup>2</sup>	MTBF	平均无故障时间	≥5000 hours
Viewing Angle (H/V)	视角 (垂直/水平)	H:100° V : 100°	Out of Control Ratio	失控比率	≥0.0003



# 楼梯屏

LED Stair Display

## 产品特点 CHARACTERISTICS



- 采用高品质3合1，贴片灯，发光角度大，画面清晰，观看效果好色彩丰富。
  - 显示方式变化多样化（图形、文字、三维、二维动画、电视画面等）。
  - 采用最简单的结构设计，方便拆装，易维护。
  - 超大画面、超强视觉、亮度高、寿命长、外观新颖独特。
- LEDs of high quality: SMD 3 in 1 ,with large viewing angle ,clear and smooth displaying effect ,rich and soft colors.
  - Any display content :Video, DVD、VCD、TV、Image、Text、Animation and others
  - Simple design of frame, easy for installation, dismantle and maintenance
  - Huge image, shocking visual experience, high brightness, long life span,and attractive shape .

## 应用领域 APPLICATION

广泛应用在舞台、酒吧、商场等公共场所的楼梯装饰。所可随意播放视频、图文、图像并茂的节目，并以实时、同步、清晰的信息传播方式播放各种信息。

Stair LED Display can be widely applied in stage,bars, shopping mall and many other public places for decoration and advertising.. It can synchronously show vivid picture , video and any information with high resolution.

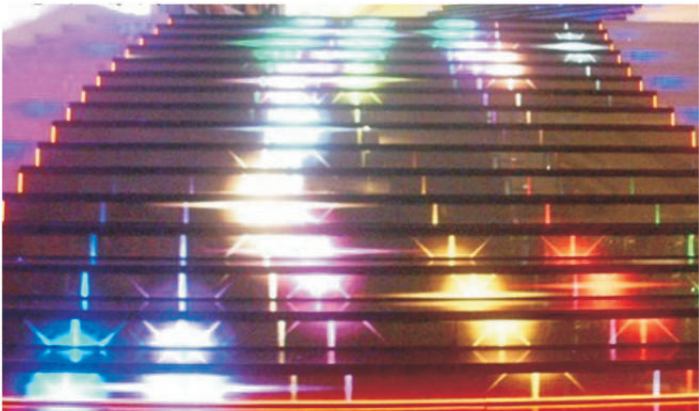

## 产品图片 PRODUCT PICTURE

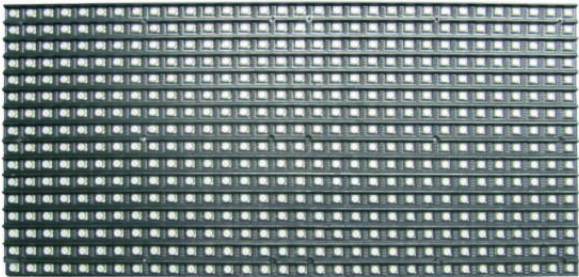

## 产品尺寸 SPECIFICATIONS

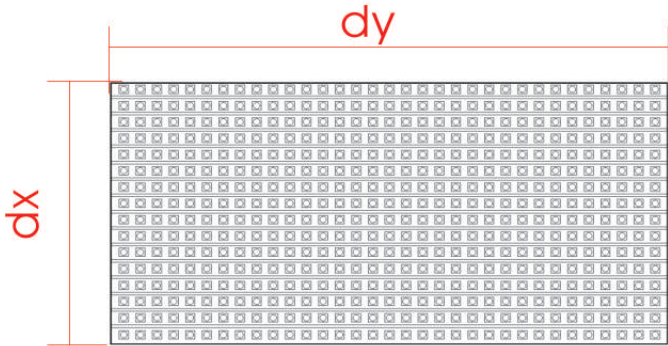

## 产品参数 PARAMETER ( 尺寸可订制 Size can be customized )

Specification	规格型号	PH6.67	Refresh Frequency	刷新率	600HZ-1500HZ
Pixel Pitch	像素点间距	6.67mm	Grey Grade	灰度等级	4096-65536
Module Resolution	像素点组成	1R1G1B	Input Voltage(Ac)	Ac输入电压	110-240V ± 10%
Pixel Composition	像素点密度	22477pixels/m²	Power Input Frequency	电源输入频率	50/60HZ
Pixel Density	LED封装	3528	Brightness Adjusting	亮度调节级别	256级自动或手动调节 Auto or manual adjustment
LED Package	扫描方式	1/8 scan	Color Temperature	色温	15000K-20000K可调 adjustable
Scanning Mode	屏幕亮度	≥1500cd/m2	Working Temperature	工作温度范围	-20℃~60℃
Cabinet Average Power	整箱平均功率	99W	Humidity	工作湿度范围	10%~90%
Cabinet Maximum Power	整箱最大功率	230W	Service Time	正常使用寿命	≥100000 hours
Woking Environment	使用环境	户内/indoor	MTBF	平均无故障时间	≥5000 hours
Cabinet Resolution	整箱分辨率	96*96	Blind Dots	杂点率	<0.0001
Cabinet Dimension	整体尺寸	640mm*640mm			



# 节能屏

LED Energy Saving Display

## 产品特点 CHARACTERISTICS



- 颜色鲜艳，响应速度快，显示效果好，可靠性高，寿命长，而且环保节能；
  - 选用低压恒流IC、高亮节能LED灯、超薄高转换效率驱动电源、特殊的控制电路设计，大大的减小了整个LED屏幕的功耗，很好的起到了节能作用；
  - 单元板的LED灯采用下倾角设计，此设计不仅可以防止显示屏直接对着大厦、高架桥或住宅区直射，造成光污染，给市人对成不必要的麻烦，也起到了减小浪费，提高有率观看角度；
  - 兼容多种信号源输入，如AV、S-Video、DVI、VGA、HDMI、SDI等；
  - 专业包装防护，对单元箱起到了良好的保护作用；
- Brilliant coloration, fast response, wonderful displaying performance, high stability, long life span and energy saving , let your display go green and reduce operation cost.
  - Professional low voltage ,constant current IC, power-saving LEDs with high brightness,ultra-slim power supply with high power factor, special design of control circuit, all these energy-saving components largely reduce power consumption of the LED display.
  - LED lights employing downward inclination angle design in order to avoid shinning directly on the building,viaduct and residential area.In addition to avoiding light pollution, this special design also offer effective viewing angle for audience.
  - Multiple signals can be processed:AV, S-Video, DVI,VGA, HDMI,SDI and so on
  - Professional package protection for cabinet.

## 应用领域 APPLICATION

广泛应用各种工程、租赁项目，可随意播放视频、图文、图像并茂的节目，并以实时、同步、清晰的信息传播方式播放各种信息。

Energy saving LED Display can be widely applied invarious programme and rental projects. It can synchronously show vivid picture ,video and any information with high resolution.



## 产品图片 PRODUCT PICTURE



## 我们是如何实现节能!

we are how to achieve energy saving!

- 采用高效节能LED灯珠；
  - 彩用 台湾ACBEL高效节能电源；
  - 采用 高效驱动芯片；
  - 采用 独立设计线路；
- the use of highly efficient energy-saving LED lamps;
  - the Taiwan Acbel high efficient and energy saving power supply;
  - the high efficiency driving chip;
  - the use of independent design line;

## 产品详情 PRODUCT DETAILS

如左图分析，50平一年可节能75,000KW,6年可以节约459,600KW。按照工业用电1.3元/度计算,六年可以节约597,480.00元。6年节约的电费完全可以购买一块新的LED显示屏。

实际上，节能不仅只是为您节约了电费,更为重要的是提高了显示屏本身的稳定性和延长了显示屏的使用寿命,节能屏一般可确保商业运营6年以上。

Like the analysis above, 50m<sup>2</sup> can save 76,500KW per year; it can save 459,600KW within six years, and can save more than 597,480 RMB. In this way ,the saving moneycan afford you to buy a new LED display. In fact, Power-saving not only save you money from energy consumption, but more important is that improved the stability of the screen and longer the using life of the screen, LED screen with power-saving solution can be made sure over 6 years advertising running.

### PH10户外全彩每平米耗电量比较分析

PH10 Outdoor full-color per square meter power consumption comparison analysis

项目 Project	常规方案 The conventional scheme	节能方案 Energy saving scheme
平均功耗 Average power consumption	0.38KW/小时	0.10KW/小时
每天播放15小时 Play 15 hours every day (8: 00-23: 00)	5.7KW	1.5KW
一个月(30天) A month ( 30 days)	171KW	45KW
一年(365天) A year ( 365 days)	2080KW	548KW
一年节约电量 Saving electricity one year	0KW	1532KW
六年节约电量 Saving electricity six years	0KW	9192KW

## 产品参数 PARAMETER ( 尺寸可订制 Size can be customized )

Specification	规格型号	Ph10
Pixel Pitch	像素点间距	10mm
Pixel Composition	像素点组成	1R1G1B
Pixel Density	像素点密度	3906pixels/m <sup>2</sup>
LED Package	LED封装	DIP 346
Drive Mode	驱动方式	恒流驱动 constant current
Scanning Mode	扫描方式	1/4 scan
Brightness of Screen	屏幕亮度	≥7500cd/m <sup>2</sup>
Horizontal Viewing Angle	水平视角	110(+55, -55)
Vertical Viewing Angle	垂直视角	45(+37.5,-7.5)
Average Power per sp.m	每平米平均功率	212W
Max Powerper sq.m	每平米最大功率	493W
Woking Environment	使用环境	户外/outdoor

Cabinet Resolution	单箱分辨率	64*64
Cabinet Dimension	箱体尺寸	1024mm*1024mm
Refresh Frequency	刷新率	600HZ-1500HZ
Grey Grade	灰度等级	4096-65536
Input Voltage(Ac)	Ac输入电压	110-240V ± 10%
Power Input Frequency	电源输入频率	50/60HZ
Brightness Adjusting	亮度调节级别	256级自动或手动调节 Auto or manual adjustment
Color Temperature	色温	15000K-20000K可调 adjustable
Working Temperature	工作温度范围	-20℃ ~ 60℃
Humidity	工作湿度范围	10% ~ 90%
Service Time	正常使用寿命	≥100000 hours
MTBF	平均无故障时间	≥5000 hours
Blind Dots	杂点率	<0.0001



# 太阳能屏

LED Solar Display

## 产品特点 CHARACTERISTICS



- 节能环保：采用太阳能供电，节能环保；
- 数据传输：GPRS/CDMA无线通讯，数据传输方便快捷；
- 超低功耗：超高亮的红色LED，能耗较低；
- 多屏切换：多达100屏信息循环播放，多种屏幕切换方式；
- 可控性强：远程屏体电源控制，可配置亮度自动调整功能；实时显示当前时间
- 稳定性强：每天可工作10小时，可连续3个阴雨天正常工作

Energy-saving and Green: powered by solar energy, which can save energy and protect the environment.  
Data transmission:using GPRS/CDMA wireless communication, makes data transmission convenient and efficient.  
Low power consumption: adopts the red lamp with super brightness to reduce power consumption.  
Muti-screen function: up to 100 information screens play cycle, featured by multiple ways of switching.  
Strong controllability: the screen can by controlled by remote power supply, the brightness could be adjusted automatically, and can be used to show the current time.  
High stability: can work for 10 hours everyday, keep working continuously for 3 rainy days.



## 应用领域 APPLICATION

广泛应用各种道路旁。可随意播放信息，并以实时、同步、清晰的信息传播方式播放各种信息。

Widely used at roadsides, all kinds of real-time information can be displayed arbitrarily,synchronous,clear.



## 产品图片& 产品尺寸 PRODUCT PICTURE&SPECIFICATIONS

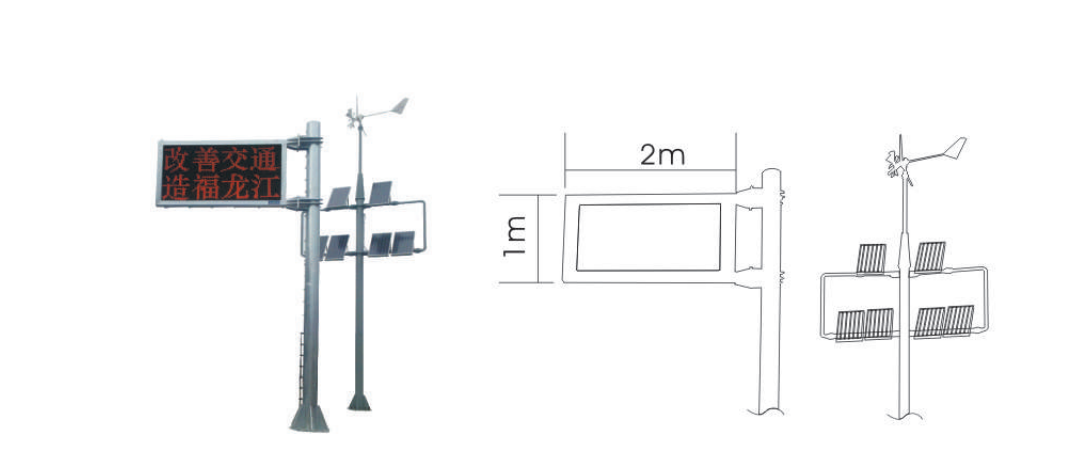

## 产品参数 PARAMETER ( 尺寸可订制 Size can be customized )

显示尺寸	P10 单色 长×高=2000mm×1000mm。
显示单元组成	解析度320×32点，采用红绿双色显示。
相邻像素间距	31.25mm
功率角	半功率角≥30°，失控点≤3‰，且为离散型。
工作功率	≤180W。
显示功能	符合GB 5768的要求。
使用寿命	≥十万小时，其他电子元器件的MTBF≥30000小时。
LED驱动模式	LED采用恒流驱动，具有过流保护功能。
视认距离	静态视认距离≥250米，动态视认距离≥210米。
刷新频率	120Hz，在汽车高速行驶时，标志的内容清晰、稳定。

Display size	height*width=000mm*1000mm
Cabinet pixel composition	320*32dots, to display in 2 colors ---red and green
Pixel-pitch	31.25mm
Power angle	half-power angle≥30° ,Defective dot rate ≤3‰, and the defective dots are discrete
Working power	≤180W。
Display function	meet GB5768 requirements
Life span	≥100,000hours. Other electronic components, MTBF≥30000 hours
LED driving method	adopts constant current driving system,provides with over-current protection.
View distance	static view distance≥250m;dynamic view distance≥210m
Refresh rate	120HZ. The information on the display can be clearly recognized when the vehicle is running at a high speed.



## 感应屏

## LED Inductive Display

## 产品特点 CHARACTERISTICS

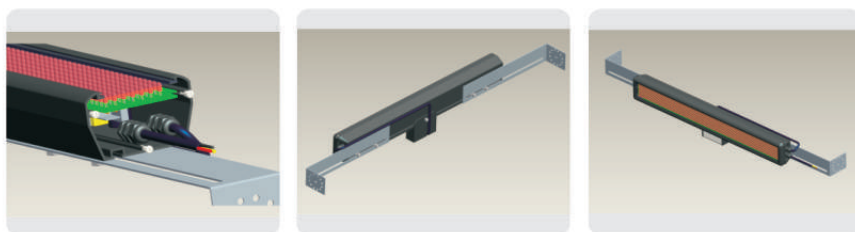

此产品是结合LED显示、异步控制以及距离感应器三者合一的电子产品，在一定的距离内感应器感应到有物体时（此距离可设置），显示部分就会显示出原先设置好的文字，是一种新颖的、操作方便、实用性强的产品，此产品适用于加油站、银行等公共场所。

可实现RF无线传输，防护等级IP65，并通过EMC认证。

Induction LED display is a trinity of LED display, asynchronous control and distance sensor. When the sensor senses an object within a certain distance(the distance can set ), the set words would be showed on the screen, which is a new,convenient and practical, thus can be used in public places such as gas station and bank. Induction LED display can send wireless signals and data, with IP65, it has passed EMC certification.



## 应用领域 APPLICATION

广泛应用各种加油站、办公场所，商业机构等出入口处。当物体接近时，可随意播放各种自定义信息。

Widely used at entrances of gas station, work space and commercial institution. The custom information can be displayed optionally when an object gets close.



### 产品图片 PRODUCT PICTURE

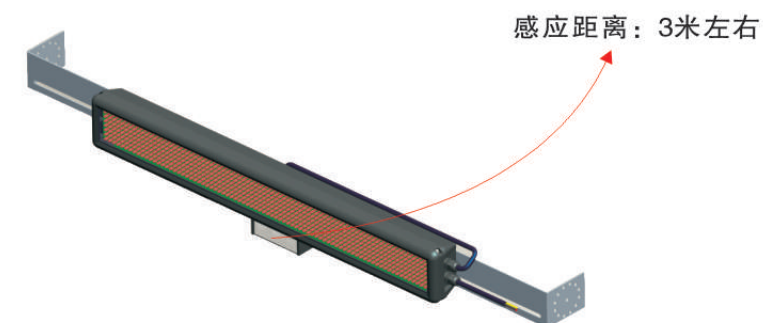

## 产品尺寸 SPECIFICATIONS

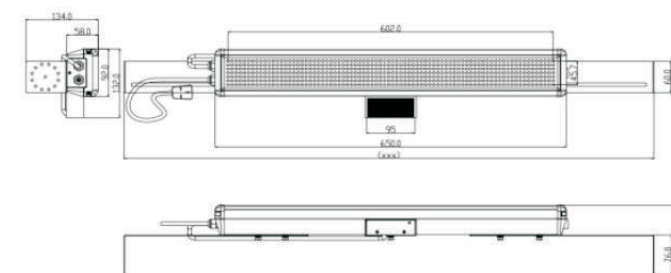

### 产品参数 PARAMETER ( 尺寸可订制 Size can be customized )

Specification	产品规格	P7.62
Pixel-pitch	像素点间距	7.62mm
Overall dimension	条屏外形尺寸	1100*132*134mm
Display dimension	条屏显示尺寸	602*45.7mm
Pixel density	像素密度	17222dots/m²
Luminous point color	发光点颜色	1R
LED encapsulation	LED封闭形式	DIP546
Module resolution	模组分辨率	79*7dots
Screen pixel	显示屏像素	553
Best view distance	最佳可视距离	1-8m
Horizontal view angle	水平视角	120°
Vertical view angle	垂直视角	45°
Brightness	显示屏亮度	2000CD/m²
Brightness level	亮度调节级别	100

driving method	驱动方式	恒流/Constant current
DC input voltage	Dc输入电压	5V
Max. Power	峰值功耗	15W
power input voltage	电源输入电压	110/220V
input frequency	输入频率	50/60HZ
working temperature	工作环境温度	-20℃~60℃
working humidity	工作环境湿度	10%~90%RH
character size	字体大小	53.3*38.1mm
transfer mode	传输方式	无线数传(射频)RF
control mode	控制方式	异步/asynchronous
screen life span	屏体寿命	100,000 hours
use life span	使用寿命	≥20000H
MTBF	平均无故障时间	≥5000H



站台屏

LED Platform Display

产品特点

CHARACTERISTICS



宽视角：采用SMD技术，使得LED显示屏在使用时具备超宽视角；  
高清晰：通过屏体色彩和亮度的同步调节，使屏体呈现细腻逼真的色彩表现；  
高亮度：在太阳直射的情况下，乘客依然能够看清现实的内容；  
兼容强：多种信号源输入，如AV、S-Video、DVI、VGA、YPbPr、HDMI、SDI、DP等；

Wide view angle: to create super-wide view angle by adopting SMD technology  
High definition: to make images showed real by sync controlling screen colors and brightness.  
High brightness:the passengers can read with no effort the content on the display in the sun  
High compatibility: multi-signal sources are acceptable,AV, S-Video, DVI, VGA,YPbPr,HDMI,SDI,DP

应用领域

APPLICATION

广泛应用各种工程、租赁项目，可随意播放视频、图文、图像并茂的节目，并以实时、同步、清晰的信息传播方式播放各种信息。

Widely used for engineering programme,rental item. It can play videos.images and text message,programme with both picture and written messagesand other information arbitrarily,synchronously, clearly.



产品图片

PRODUCT PICTURE



产品尺寸

SPECIFICATIONS

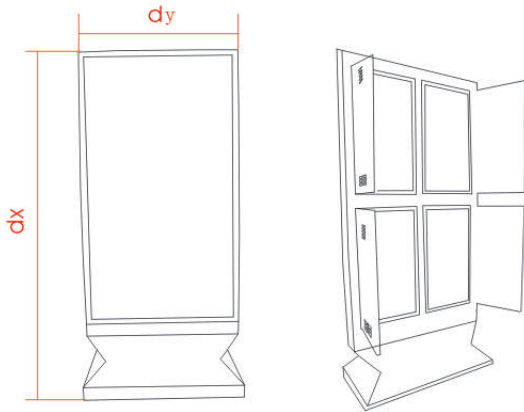

产品参数

PARAMETER ( 尺寸可订制 Size can be customized )

Specification	规格型号	ph8
Pixel-pitch	像素点间距	8mm
Pixel density	像素点密度	15625pixels/m²
Pixel composition	像素点组成	1R1G1B
LED encapsulation	LED封装	3 in 1
Scan mode	扫描方式	1/4 scan
Module resolution	模组分辨率	32*16
Module size	模组尺寸	256*128mm
Driving method	驱动方式	恒流/Constant current
Best view distance	最佳视距	5-60m
Horizontal view angle	水平视角	60
Vertical view angle	垂直视角	60
Brightness	显示屏亮度	≥5000nit
Color temperature	色温	3200-9500K可调 adjustable

control mode	控制方式	异步/asynchronous
Gray level	灰度级别	4096
Refresh rate	刷新频率	≥300HZ
repetition frequency	换帧频率	50/60HZ
Brightness level	亮度调节级别	100level
DC input voltage	Dc输入电压	5V
Input power frequency	电源输入频率	50/60HZ
Screen Average power	整屏平均功率	≤0.83KW
Screen Average power	整屏最大功率	≤1.92KW
Working environment	使用环境	户外/outdoor
working temperature	工作温度范围	-20~50℃
working humidity	工作湿度范围	10%~90%
screen life span	使用寿命	100000hours
MTBF	平均无故障时间	≥5000hours







售前服务 Pre-sale service

- ( 1 ) 24小时全球客户服务热线，免费为客户提供技术支持。

( 2 ) 我们会根据您的询盘信息，进行严格的内部项目评审。

( 3 ) 我们会依据评审意见，出具详细的技术解决方案。

( 4 ) 我们会为您提供免费的现场效果设计，包括平面效果和Flash动画效果。
- ( 1 ) We provide 24 hours global customer service hotline and free technical support.

( 2 ) We make strict internal project appraisal according to your inquiry.

( 3 ) We issue detailed technical solutions on the basis of evaluation.

( 4 ) We offer free on-site effect design, which include plane effect and flash animation effect.

售中服务 (工程服务) In-sale Service

- ( 1 ) 针对项目工程，我们将免费为您出具具有资质的安装结构图纸。

( 2 ) 大型项目工程，我们将免费指派工程师现场指导安装调试。

( 3 ) 根据您的需求，我们可以提供现场安装调试服务，即交钥匙工程。
- ( 1 ) For common project, we issue certified high quality installation structure drawings free of charge.

( 2 ) For large scale project, we assign engineers to provide on-the-spot installation and debugging guidance free of charge

( 3 ) we provide on-site installation and debugging guidance according to your request, namely turnkey projects.

售后服务 After Sales Service

- ( 1 ) 热线畅通：所有业务人员及售后服务专员24小时待机，节假日固定电话实现自动转接。

( 2 ) 响应快捷：客诉电话30分钟内提供解决方案，一般故障24小时内解决，重大故障72小时内排除。

( 3 ) 终身维护：我司所有产品均享有终身维护服务，并确保每个项目均保留同规格、同批次的备品、备件和专用工具，保修期后客户只需支付相应成本费用。

( 4 ) 增值服务：在保修期内我司提供每年免费上门服务，免费系统升级，免费设备保养，免费人员培训和重大活动时的远程技术指导或现场技术支持。
- ( 1 ) Accessible hotline: all salesmen and after sales specialists are accessible by phone in 24 hours, and our office phone calls can automatically forward to salesmen or after sales specialists' cell phone during holidays.

( 2 ) Quick response: we provide solution within 30 minutes, solve general failures within 24 hours and solve major failures within 72 hours since receipt of telephone complaints.

( 3 ) Lifetime maintenance: we offer lifetime maintenance for all of our products and keep spare parts, finished products and exclusive tools in the same parameters with each project. While the warranty expires, you only have to pay material costs.

( 4 ) Value-added service: we provide free annual door-to-door service, system update, products maintenance, personnel training and remote/on-site technical support for important activities.

品质 Quality

能力 Ability

诚信 Integrity

责任 Responsibility





## NOTE

---

---

---

---

---

---

---

---

---

---

---

---